

BLUETOOTH® AUDIO STREAMING

- Be sure Bluetooth on your device is turned on.
- Main Menu > Bluetooth > Streaming > Pairing
(or press and hold the MASTER VOL knob to quickly enable pairing)
- Enable mobile device's Bluetooth pairing mode.
- Once visible, pair with "EV EVOLVE"

EV QUICKSMART MOBILE

Quickly and wirelessly configure, control, and monitor up to six EVOLVE 50 systems simultaneously, and receive important notifications during a performance.

BLUETOOTH® INPUT TUNING

- MUTE the main OUTPUT GAIN (A) of the EVOLVE 50.
(Rotate the MASTER VOL knob counter-clockwise until MUTE)
- Turn the AUX 3 TRIM knob (B) to $-\infty$ (full counter-clockwise)
- Start playing loud (low dynamic range) music from the paired mobile device.
- Turn up mobile device to $\approx 75\%$ of maximum volume.
- Start turning up AUX 3 knob (B) – with OUTPUT GAIN (A) still at MUTE – until signal meter starts clipping (PK). Back off until no clipping notification (PK) is shown.
- Increase OUTPUT GAIN (A) until desired output level is achieved. Keep in mind LIMIT notifications.

EVOLVE 50
QUICK START GUIDE

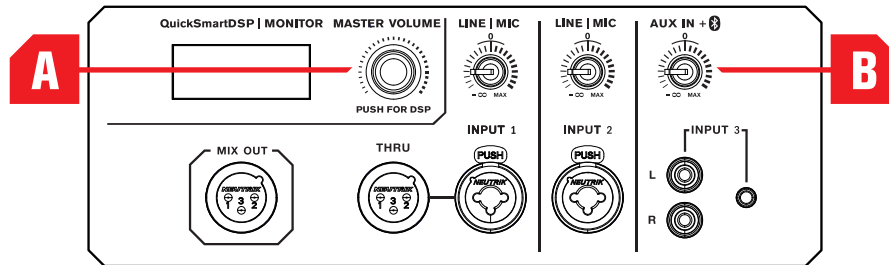

PRESETS

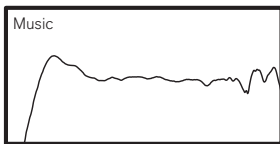

Music
For recorded audio (e.g. *.wav, *.flac, *.mp3) playback

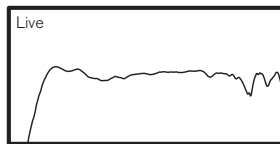

Live
Uncolored and flat for live instruments

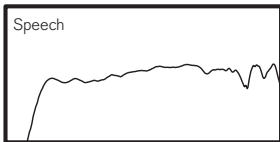

Speech
Optimized for voice intelligibility and clarity

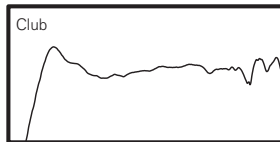

Club
Low frequency boost for EDM and Hip-Hop music

RECOMMENDED CONFIGURATION

Mode: Live
Phantom 1: On

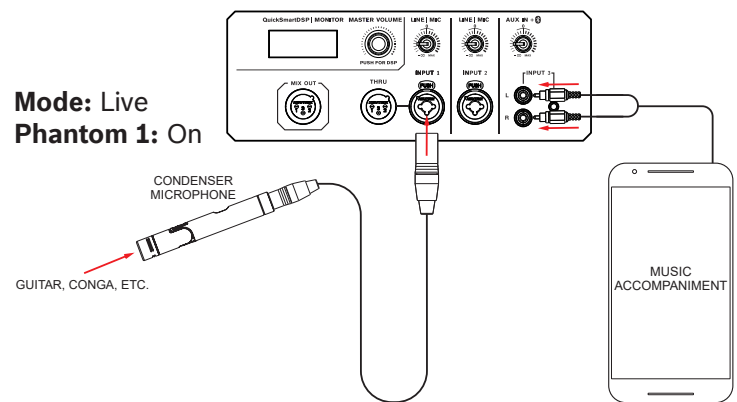

CAUTION

Do not attempt to move this loudspeaker system when it is fully assembled. You may damage the system or cause personal injury.