



STAIRVILLE

Maniac LED-FX1
LED flower effect

Musikhaus Thomann
Thomann GmbH
Hans-Thomann-Straße 1
96138 Burgebrach
Germany
Telephone: +49 (0) 9546 9223-0
E-mail: info@thomann.de
Internet: www.thomann.de

03.02.2020, ID: 453753

Table of contents

1	General information	5
	1.1 Further information.....	6
	1.2 Notational conventions.....	7
	1.3 Symbols and signal words.....	7
2	Safety instructions	10
3	Features	16
4	Installation	17
5	Starting up	21
6	Connections and controls	24
7	Operating	27
	7.1 Starting the device.....	27
	7.2 Main menu.....	27
	7.3 Menu overview.....	33
	7.4 Functions in 4-channel DMX mode.....	34
	7.5 Functions in 6-channel DMX mode.....	36

8	Maintenance.....	39
9	Technical specifications.....	42
10	Plug and connection assignments.....	44
11	Troubleshooting.....	45
12	Cleaning.....	47
13	Protecting the environment.....	48

1 General information

This user manual contains important information on the safe operation of the device. Read and follow all safety notes and all instructions. Save this manual for future reference. Make sure that it is available to all persons using this device. If you sell the device to another user, be sure that they also receive this manual.

Our products and user manuals are subject to a process of continuous development. We therefore reserve the right to make changes without notice. Please refer to the latest version of the user manual which is ready for download under www.thomann.de.

1.1 Further information

On our website (www.thomann.de) you will find lots of further information and details on the following points:

Download	This manual is also available as PDF file for you to download.
Keyword search	Use the search function in the electronic version to find the topics of interest for you quickly.
Online guides	Our online guides provide detailed information on technical basics and terms.
Personal consultation	For personal consultation please contact our technical hotline.
Service	If you have any problems with the device the customer service will gladly assist you.

1.2 Notational conventions

This manual uses the following notational conventions:

Letterings

The letterings for connectors and controls are marked by square brackets and italics.

Examples: *[VOLUME]* control, *[Mono]* button.



Displays



Texts and values displayed on the device are marked by quotation marks and italics.

Examples: *'24ch'*, *'OFF'*.

1.3 Symbols and signal words

In this section you will find an overview of the meaning of symbols and signal words that are used in this manual.

Signal word	Meaning
DANGER!	This combination of symbol and signal word indicates an immediate dangerous situation that will result in death or serious injury if it is not avoided.
WARNING!	This combination of symbol and signal word indicates a possible dangerous situation that can result in death or serious injury if it is not avoided.
NOTICE!	This combination of symbol and signal word indicates a possible dangerous situation that can result in material and environmental damage if it is not avoided.
Warning signs	Type of danger
	Warning – high-voltage.
	Warning – hot surface.

Warning signs	Type of danger
	<p>Warning – dangerous optical radiation.</p>
	<p>Warning – suspended load.</p>
	<p>Warning – danger zone.</p>

2 Safety instructions

Intended use

This device is intended for use as an electronic lighting effect by means of LED technology. The device is designed for professional use and is not suitable for use in households. Use the device only as described in this user manual. Any other use or use under other operating conditions is considered to be improper and may result in personal injury or property damage. No liability will be assumed for damages resulting from improper use.

This device may be used only by persons with sufficient physical, sensorial, and intellectual abilities and having corresponding knowledge and experience. Other persons may use this device only if they are supervised or instructed by a person who is responsible for their safety.

Extend the life of the device by regular breaks in operation and avoid switching it on and off frequently. This device is not suitable for continuous use.

Safety**DANGER!****Danger for children**

Ensure that plastic bags, packaging, etc. are disposed of properly and are not within reach of babies and young children. Choking hazard!

Ensure that children do not detach any small parts (e.g. knobs or the like) from the unit. They could swallow the pieces and choke!

Never let children unattended use electrical devices.

**DANGER!****Electric shock caused by high voltages inside**

Within the device there are areas where high voltages may be present. Never remove any covers.

There are no user-serviceable parts inside.

Do not use the device if covers, protectors or optical components are missing or damaged.



DANGER!

Electric shock caused by short-circuit

Always use proper ready-made insulated mains cabling (power cord) with a protective contact plug. Do not modify the mains cable or the plug. Failure to do so could result in electric shock/death or fire. If in doubt, seek advice from a registered electrician.



WARNING!

Eye damage caused by high light intensity

Never look directly into the light source.



WARNING!

Risk of epileptic shock

Strobe lighting can trigger seizures in photosensitive epilepsy. Sensitive persons should avoid looking at strobe lights.



NOTICE!

Risk of fire

Do not block areas of ventilation. Do not install the device near any direct heat source. Keep the device away from naked flames.



NOTICE!

Operating conditions

This device has been designed for indoor use only. To prevent damage, never expose the device to any liquid or moisture. Avoid direct sunlight, heavy dirt, and strong vibrations.

Only operate the device within the ambient conditions specified in the chapter 'Technical specifications' of this user manual. Avoid heavy temperature fluctuations and do not switch the device on immediately after it was exposed to temperature fluctuations (for example after transport at low outside temperatures).

Dust and dirt inside can damage the unit. When operated in harmful ambient conditions (dust, smoke, nicotine, fog, etc.), the unit should be maintained by qualified service personnel at regular intervals to prevent overheating and other malfunction.



NOTICE!

Power supply

Before connecting the device, ensure that the input voltage (AC outlet) matches the voltage rating of the device and that the AC outlet is protected by a residual current circuit breaker. Failure to do so could result in damage to the device and possibly injure the user.

Unplug the device before electrical storms occur and when it is unused for long periods of time to reduce the risk of electric shock or fire.

3 Features

The LED effect is suitable for almost all applications, for example in clubs, bars, small stages and theatres.

Special features of the device:

- Dynamic LED water flow effect
- 1 × white light LED (100 W)
- Rotation mirror for guiding the light rays
- Automatic mode and sound control
- Master / Slave operation

For technological reasons, the light output of LEDs decreases over their lifetime. This effect increases with higher operating temperature. You can extend the service life of the illuminants by providing adequate ventilation and operating the LEDs with the lowest possible brightness.

4 Installation

Unpack and check carefully there is no transportation damage before using the unit. Keep the equipment packaging. To fully protect the product against vibration, dust and moisture during transportation or storage use the original packaging or your own packaging material suitable for transport or storage, respectively.



WARNING!

Risk of injury caused by falling objects

Make sure that the installation complies with the standards and rules that apply in your country. Always secure the device with a secondary safety attachment, such as a safety cable or a safety chain.



NOTICE!

Risk of overheating

The distance between light output and the illuminated surface must be more than 1.5 m (19.7in).

Provide sufficient ventilation.

The ambient temperature must always be below 40 °C (104 °F).



NOTICE!

Use of stands

When mounting the device onto a stand, ensure that the stand is in a safe and stable position and that the weight of the device does not exceed the maximum permissible load capacity of the stand.

**NOTICE!****Possible data transmission errors**

For error-free operation make use of dedicated DMX cables and do not use ordinary microphone cables.

Never connect the DMX input or output to audio devices such as mixers or amplifiers.

Mounting options

You can install the unit in hanging or standing position. When in use, the device must always be attached to a solid surface or an approved truss. Use the openings provided on the two-piece bracket for attaching.

Always work from a stable platform whenever installing, moving or servicing the unit. In doing so, the area underneath the unit must be cordoned off.

The safety cable must be threaded through the safety eyelet on the rear side of the unit.



Please note that this device must not be connected to a dimmer.

5 Starting up

Create all connections while the device is off. Use the shortest possible high-quality cables for all connections. Take care when running the cables to prevent tripping hazards.

Connections in DMX mode

Connect the DMX input of the device to the DMX output of a DMX controller or another DMX device. Connect the output of the first DMX device to the input of the second one, and so on to form a daisy chain. Always ensure that the output of the last DMX device in the daisy chain is terminated with a resistor ($110\ \Omega$, $\frac{1}{4}\text{ W}$).

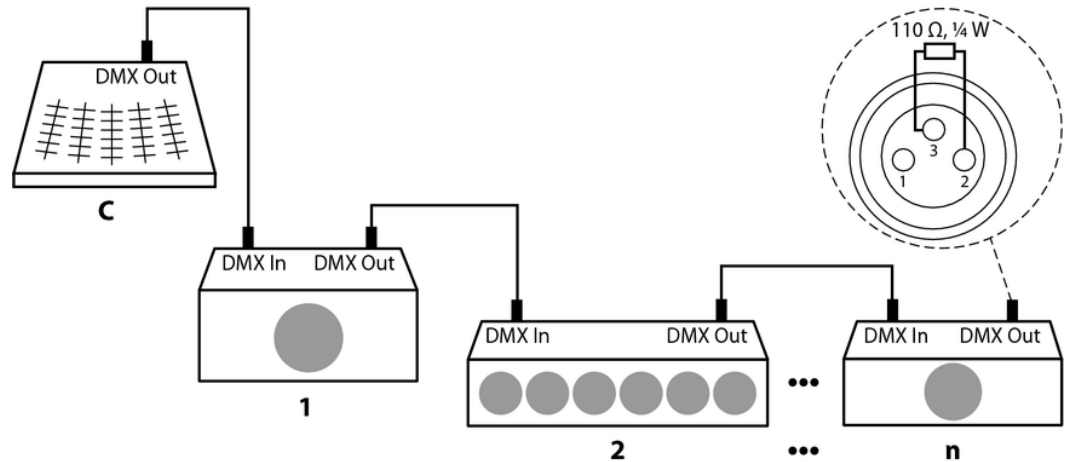

Connections in master/slave mode

When you configure a group of devices in master/slave mode, the first unit will control the other units for an automatic, sound-activated, synchronized show. This function is ideal when you want to start a show immediately. Connect the DMX output of the master device to the DMX input of the first slave device. Then connect the DMX output of the first slave device to the DMX input of the second slave device and so on.

6 Connections and controls

Rear panel

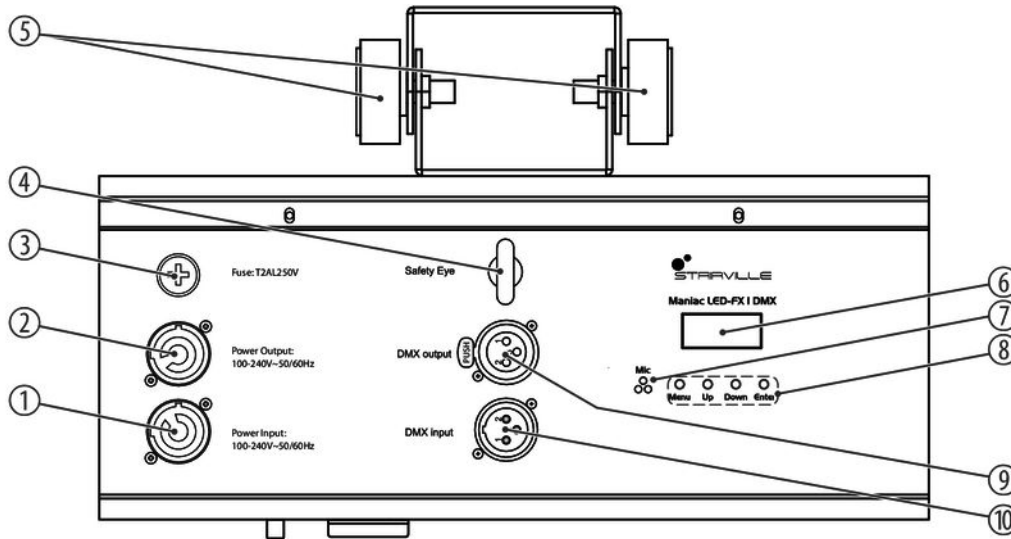

1	<p><i>[Power output]</i></p> <p>IEC chassis socket to power another device with mains voltage.</p> <p><i>[Power input]</i></p> <p>IEC chassis plug for power supply with fuse holder. Should the fuse have blown, disconnect the unit from the power supply and replace the fuse with a new fuse of the same type.</p>
2	<p><i>[Safety Eye]</i></p> <p>Safety cable eyelet.</p>
3	Mounting bracket with knurled screws for fixing
4	Display
5	<p><i>[Mic]</i></p> <p>Microphone for sound control.</p>
6	<p>Control buttons</p> <p><i>[Menu]</i>: Calls up the main menu or a submenu.</p> <p><i>[Up]</i>: Button to increase the displayed value by one.</p> <p><i>[Down]</i>: Button to decrease the displayed value by one.</p>

	<i>[Enter]</i> : Confirms a selected value.
7	<i>[DMX output]</i> DMX output
8	<i>[DMX input]</i> DMX input

7 Operating

7.1 Starting the device

Connect the device to the power supply to start operation. After a few seconds the unit is ready for use.

7.2 Main menu

Press *[Menu]* to activate the main menu. Use *[Up]* or *[Down]* to change the respectively displayed value. When the display shows the desired value, press *[Enter]*.

DMX address

Press *[Menu]*. Use *[Up]* or *[Down]* to select the menu item 'Addr'. Press *[Enter]*. Set the number of the first DMX channel to be used by the device (DMX address). Use *[Up]* or *[Down]* to select a value between 1 and 512 (display shows 'd.001' ... 'd.512').

When the display shows the desired value press *[Enter]* to confirm the selection and then *[Menu]* to return to the parent menu.

Make sure that this number matches the configuration of your DMX controller.

DMX mode

Press *[Menu]*. Use *[Up]* or *[Down]* to select the menu item 'chnd'. Press *[Enter]*. Select either 4-channel DMX mode (display shows '4Ch') or 6-channel DMX mode (display shows '6Ch').

When the display shows the desired value press *[Enter]* to confirm the selection and then *[Menu]* to return to the parent menu.

Operating mode 'Slave'

Press *[Menu]*. Use *[Up]* or *[Down]* to select the menu item 'SLnd'. Press *[Enter]*. Select either slave mode 1 (display shows 'SL1') or slave mode 2 (display shows 'SL2'). In slave mode 1, the device now follows exactly the guidance of the master device. In slave mode 2, the device follows the master unit with slight variations to bring variety to the stage show.

Confirm with *[Enter]*. Then press *[Menu]* to return to the parent menu.

Operating mode 'Master'

Press *[Menu]*. Use *[Up]* or *[Down]* to select the menu item 'Mast'. Press *[Enter]*. Switch the master mode either on (display shows 'On') or off (display shows 'off').

Confirm with *[Enter]*. Then press *[Menu]* to return to the parent menu.

Operating mode 'Automatic'

Press *[Menu]*. Use *[Up]* or *[Down]* to select the menu item 'Shnd'. Press *[Enter]*. Press *[Up]* or *[Down]* to choose between 'Sh0' (random combination of all eight built-in shows) or one of shows 1 to 8 (display shows 'Sh1' ... 'Sh8'). When the display shows the desired value, press *[Enter]*.

To set the running speed, select a value between Sp00 'Sp00' (slow) and 'Sp99'.

When the display shows the desired value press *[Enter]* to confirm the selection and then *[Menu]* to return to the parent menu.

Sound control

Press *[Menu]*. Use *[Up]* or *[Down]* to select the menu item 'Soun'. Press *[Enter]*. Turn the sound control for the automatic show 'Sh0' either on (display shows 'On') or off (display shows 'off').

Confirm with *[Enter]*. Then press *[Menu]* to return to the parent menu.

Microphone sensitivity

Press *[Menu]*. Use *[Up]* or *[Down]* to select the menu item 'Sens'. Press *[Enter]*. Press *[Enter]*. Use *[Up]* or *[DOWN]* to select a value between '0' and '100'. When the display shows the desired value, press *[Enter]*. Then press *[Menu]* to return to the parent menu.

Behaviour on DMX signal failure

Press *[Menu]*. Use *[Up]* or *[Down]* to select the menu item 'dMst'. Press *[Enter]*.

Select the device's behaviour on a DMX failure.

- 'bLnd': Blackout
- 'Lst': Maintaining the last set mode
- 'Show': Starting an automatic show

When the display shows the desired value, press *[Enter]*. Then press *[Menu]* to return to the parent menu.

Display off time

Press *[Menu]*. Use *[Up]* or *[Down]* to select the menu item 'Led'. Press *[Enter]*.

Use *[Up]* or *[Down]* to choose between 'On' (backlight permanently on) and 'off' (backlight turns off automatically after a few seconds).

When the display shows the desired value, press *[Enter]*. Then press *[Menu]* to return to the parent menu.

Display inversion

Press *[Menu]*. Use *[Up]* or *[Down]* to select the menu item 'disp'. Press *[Enter]*.

To rotate the display by 180 °, use *[Up]* or *[Down]* to select 'dsip'. Select 'Disp' for normal display.

When the display shows the desired value, press *[Enter]*. Then press *[Menu]* to return to the parent menu.

Manual settings

Press *[Menu]*. Use *[Up]* or *[Down]* to select the menu item 'Manu'. Press *[Enter]*.

Use *[Up]* or *[Down]* to choose between 'Dimm' (overall brightness), 'Stro' (strobe effect speed), 'Glas' (replaceable effect wheel rotation) and 'Rota' (reflector disc rotation). When the display shows the desired menu item, press *[Enter]*. Use *[Up]* or *[Down]* to set the respective value.

When the display shows the desired value press *[Enter]* to confirm the selection and then *[Menu]* to return to the parent menu.

Device temperature

Press *[Menu]*. Use *[UP]* or *[DOWN]* to select the menu item 'Temp'. Press *[ENTER]*. The current device temperature will appear on the display.

Press *[Menu]* to return to the parent menu.

Operating hours display

Press *[Menu]*. Use *[Up]* or *[Down]* to select the menu item 'Fhrs'. Press *[Enter]*. The number of operating hours of the device will appear on the display.

Press *[Menu]* to return to the parent menu.

Software version of the device

Press *[Menu]*. Use *[UP]* or *[DOWN]* to select the menu item 'Ver'. Press *[ENTER]*. The software version of the device will appear on the display.

Press *[Menu]* to return to the parent menu.

7.3 Menu overview

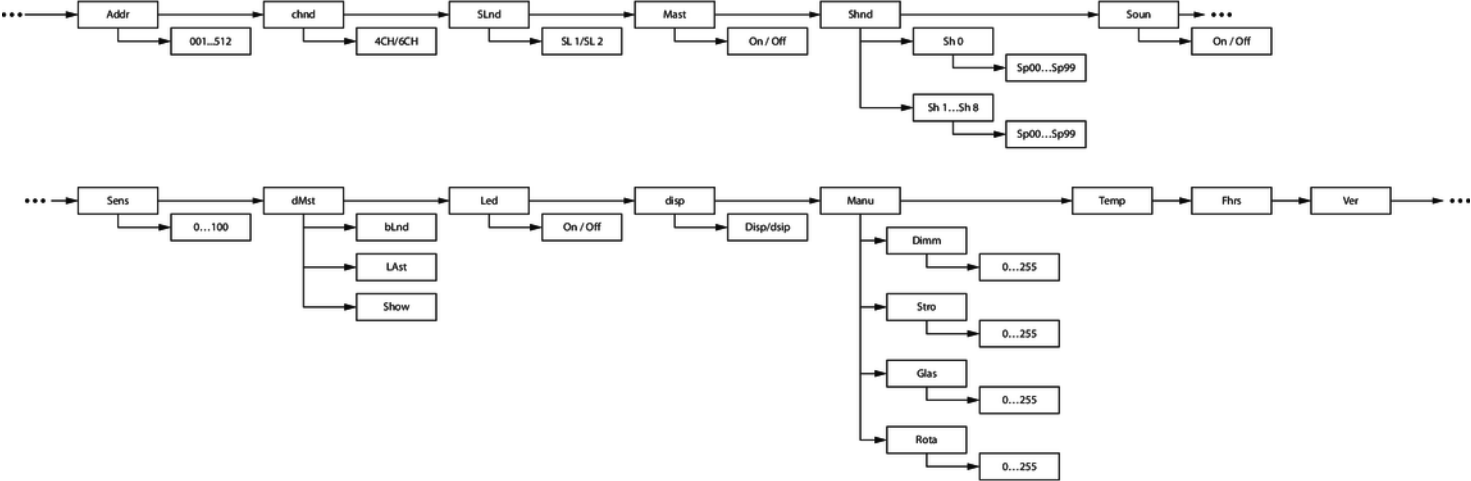

7.4 Functions in 4-channel DMX mode

Channel	Value	Function
1	0...255	Master dimmer (0 % to 100 %)
2	Strobe effect	
	0...31	Blackout
	32...63	Full brightness
	64...95	Stroboscope effect, increasing speed
	96...127	Full brightness
	128...159	Pulse Strobe effect, increasing speed
	160...191	Full brightness
	192...223	Random Strobe effect, increasing speed
	224...255	Full brightness
3	Reflector disc rotation	

Channel	Value	Function
	0...127	Rotation to a fixed position
	128...191	Clockwise rotation, speed decreasing
	192...255	Counter-clockwise rotation, speed increasing
4	Effect wheel rotation	
	0...127	Rotation to a fixed position
	128...191	Clockwise rotation, speed decreasing
	192...255	Counter-clockwise rotation, speed increasing

7.5 Functions in 6-channel DMX mode

Channel	Value	Function
1	0...255	Master dimmer (0 % to 100 %)
2	Strobe effect	
	0...31	Blackout
	32...63	Full brightness
	64...95	Stroboscope effect, increasing speed
	96...127	Full brightness
	128...159	Pulse Strobe effect, increasing speed
	160...191	Full brightness
	192...223	Random Strobe effect, increasing speed
	224...255	Full brightness
3	Automatic show	

Channel	Value	Function
	0...3	No function
	4...31	Automatic Show 0 (random combination of all eight built-in shows)
	32...59	Automatic show 1
	60...87	Automatic show 2
	88...115	Automatic show 3
	116...143	Automatic show 4
	144...171	Automatic show 5
	172...199	Automatic show 6
	200...227	Automatic show 7
	228...255	Automatic show 8
4	0...255	Running speed automatic show, increasing
5	Reflector disc rotation	
	0...127	Rotation to a fixed position

Channel	Value	Function
	128...191	Clockwise rotation, speed decreasing
	192...255	Counter-clockwise rotation, speed increasing
6	Effect wheel rotation	
	0...127	Rotation to a fixed position
	128...191	Clockwise rotation, speed decreasing
	192...255	Counter-clockwise rotation, speed increasing

8 Maintenance



DANGER!

Electric shock caused by high voltages inside

Within the device there are areas where high voltages may be present.

Completely disconnect the device from the power supply before you open or remove covers. Mount all covers and attach them firmly before connecting the device again.

Do not use the device if covers, protectors or optical components are missing or damaged.



WARNING!

Risk of burns at the surface and inside of the device

The surface and the inner parts of the device can become very hot during operation.

After switching off the device wait for at least 15 minutes before you start any maintenance activities.

Replacing the static effect glass

The device is equipped with a rotatable effect glass. In addition, a static effect glass can be attached. The static effect glass is replaceable.

- 1.** ▶ Make sure that the device is turned off, disconnected from the mains and completely cooled down.
- 2.** ▶ Position the device so that the underside is easily accessible.

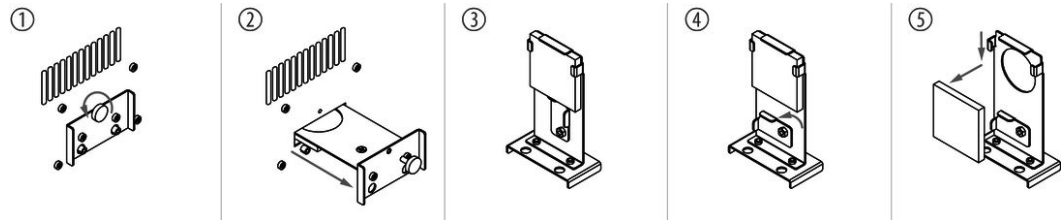

- 3.** ➤ Unscrew the knurled screw on the underside of the housing completely (1) and pull out the holder of the static effect glass (2).
- 4.** ➤ Position the lens holder as shown (3).
- 5.** ➤ Turn the retaining latch by 90° to the left (4) to release the metal plate.
- 6.** ➤ Slide the metal plate down and remove it (5).
- 7.** ➤ Put on another effect glass. Replace the metal plate and slide it up into the holder.
- 8.** ➤ Turn the retaining latch back to the right to fix the metal plate.
- 9.** ➤ Insert the effect glass holder back into the slot on the back of the device and tighten the knurled screw.

⇒ The static effect glass is replaced. You can reconnect the device to the mains.

9 Technical specifications

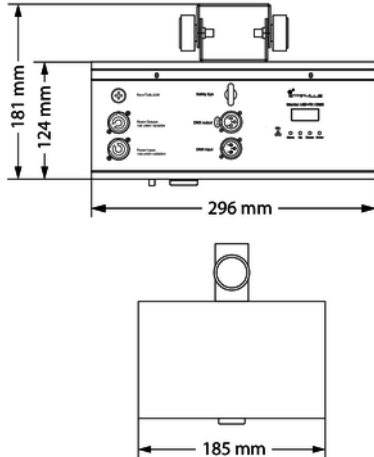

Light source	1 × white light LED, 100 W	
Light source properties	Colour temperature	7400 K
	Colour rendering index	CRI 70
Optical properties	Beam angle	80 °
Control	DMX	
Number of DMX channels	4 or 6	
Input connections	Voltage supply	IEC chassis plug C14
Output connections	DMX control	XLR chassis socket, 3-pin
Power consumption	max. 110 W	
Operating supply voltage	100 – 240 V ~ 50/60 Hz	
Fuse	5 mm × 20 mm, 2 A, 250 V, slow-blow	
Protection class	IP20	

Mounting options	Wall or ceiling	
Dimensions (W × H × D)	296 mm × 181 mm × 185 mm	
Weight	4.1 kg	
Ambient conditions	Temperature range	0 °C...40 °C
	Relative humidity	50 %, non-condensing

Further information

Type	Water effect
Rechargeable battery operation	No
DMX control	Yes
Master/Slave	Yes
Remote control	Not possible
Sound control	Yes
Display	Yes

10 Plug and connection assignments

Introduction

This chapter will help you select the right cables and plugs to connect your valuable equipment so that a perfect light experience is guaranteed.

Please take our tips, because especially in 'Sound & Light' caution is indicated: Even if a plug fits into a socket, the result of an incorrect connection may be a destroyed DMX controller, a short circuit or 'just' a not working light show!

DMX connections

The unit offers a 3-pin XLR socket for DMX output and a 3-pin XLR plug for DMX input. Please refer to the drawing and table below for the pin assignment of a suitable XLR plug.



Pin	Configuration
1	Ground, shielding
2	Signal inverted (DMX-, 'cold signal')
3	Signal (DMX+, 'hot signal')

11 Troubleshooting



NOTICE!

Possible data transmission errors

For error-free operation make use of dedicated DMX cables and do not use ordinary microphone cables.

Never connect the DMX input or output to audio devices such as mixers or amplifiers.

In the following we list a few common problems that may occur during operation. We give you some suggestions for easy troubleshooting:

Symptom	Remedy
The unit does not work, no light	Check the mains connection.
Apparently no function despite proper power supply	Check if the unit is in DMX mode or in 'slave' mode. If so, check the unit in another mode.
No response to the DMX controller	1. Check whether the DMX controller is switched on. Check the DMX connectors and cables for proper connection.
	2. Check the address settings and the DMX polarity.
	3. Try using another DMX controller.
	4. Check to see if the DMX cables run near or alongside to high voltage cables that may cause damage or interference to DMX interface circuits.

If the procedures recommended above do not succeed, please contact our Service Center. You can find the contact information at www.thomann.de.

12 Cleaning

Optical lenses

Clean the optical lenses, that are accessible from the outside, regularly in order to optimize the light output. The frequency of cleaning depends on the operating environment: wet, smoky or particularly dirty surroundings can cause more accumulation of dirt on the optics of the device.

- Clean with a soft cloth using our lamp and lens cleaner (item no. 280122).
- Always dry the parts carefully.

Fan grids

The fan grids of the device must be cleaned of any contamination, such as dust, etc. on a regular basis. Before cleaning, switch off the device and disconnect mains-operated devices from the mains. Only use pH-neutral, solvent-free and non-abrasive cleaning agents. Clean the unit with a slightly damp lint-free cloth.

13 Protecting the environment

Disposal of the packaging material



For the transport and protective packaging, environmentally friendly materials have been chosen that can be supplied to normal recycling.

Ensure that plastic bags, packaging, etc. are properly disposed of.

Do not just dispose these materials with your normal household waste, but make sure that they are fed to a recovery. Please follow the notes and markings on the packaging.

Disposal of batteries



Batteries must not be disposed of as domestic waste or thrown into fire. Dispose of the batteries according to national or local regulations regarding hazardous waste. To protect the environment, dispose of empty batteries at your retail store or at appropriate collection sites.

Disposal of your old device



This product is subject to the European Waste Electrical and Electronic Equipment Directive (WEEE) in its currently valid version. Do not dispose with your normal household waste.

Dispose this device through an approved waste disposal firm or through your local waste facility. When discarding the device, comply with the rules and regulations that apply in your country. If in doubt, consult your local waste disposal facility.



Musikhaus Thomann · Hans-Thomann-Straße 1 · 96138 Burgebrach · Germany · www.thomann.de